

# 7500 FORGED SERIES

# 3,200 LBS



## FEATURES

**KINGPIN:** 1" diameter integral kingpin and nut  
**RACEWAY:** 1/2" diameter upper ball race with tapered roller thrust bearing  
**BUSHING:** Roller bearings with drilled hardened steel spanner bushing and steel side washers  
**AXLE&NUT:** 3/4" axle and lock nut

**FINISH:** Corrosion resistant bright zinc  
**LUBRICATION:** Grease nipple in lower race  
**HARDENED:** Drop forged hardened rolled in raceway  
**LEG SPACING:** 3 1/2"  
**SPECIAL:** Robotic welded. AISI 1045 drop forged steel top plate

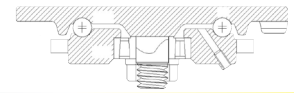

### EXCELLENT FOR:

- Industrial platforms
- Garbage & cargo containers
- Dolly carts
- Heavy loads
- Factory use
- Heavy material handling
- Abusive applications



### OPTIONS:

- TSB Thumb Screw Brake
- UWB Universal Wheel Brake
- BR Bronze Bearing
- DB Delrin Bearing
- PB Precision Ball Bearing
- SWH Heat-treated Side Washer
- TG Thread Guards
- Z Zerk in Axle

### SPECIAL:

Drop forged steel top plate AISI 1045.  
 Double deep grooved raceway.

WHEEL		CASTER				PART NUMBER								
Diameter	Tread Width	Capacity Lbs.	Bearing Type	Swivel Radius	Overall Height	Wheel Type	Swivel	Caster Weight (lbs)	Rigid	Caster Weight (lbs)				
6"	3"	750	Roller	5 9/32"	8"	Moldon Rubber	S7506-A53J-MR-RB	20.78	R7506-A53J-MR-RB	15.90				
		750	Tapered			Moldon Rubber - TB	S7506-A53J-MR-TB	20.27	R7506-A53J-MR-TB	15.39				
		2,000	Roller			Phenolic	S7506-A53J-PH-RB	18.40	R7506-A53J-PH-RB	13.52				
		2,000	Roller			Moldon Urethane	S7506-A53J-UR-RB	21.90	R7506-A53J-UR-RB	17.02				
		2,000	Tapered			Moldon Urethane - TB	S7506-A53J-UR-TB	23.37	R7506-A53J-UR-TB	18.49				
		2,400	Roller			HD Moldon Urethane	S7506-A53J-URH-RB	23.50	R7506-A53J-URH-RB	18.62				
		2,400	Tapered			HD Moldon Urethane - TB	S7506-A53J-URH-TB	21.65	R7506-A53J-URH-TB	16.77				
		2,500	Roller			Solid Steel	S7506-A53J-SS-RB	25.70	R7506-A53J-SS-RB	20.82				
		2,500	Roller			V Groove	S7506-A53J-VG-RB	26.00	R7506-A53J-VG-RB	21.12				
		3,200	Tapered			Ductile Iron - TB	S7506-A53J-DI-TB	23.40	R7506-A53J-DI-TB	18.52				
		3,200	Tapered			Solid Steel - TB	S7506-A53J-SS-TB	22.25	R7506-A53J-SS-TB	17.37				
		3,200	Tapered			V Groove - TB	S7506-A53J-VGFS-TB	32.65	R7506-A53J-VGFS-TB	27.77				
		8"	3"			900	Roller	6 1/8"	10 1/2"	Moldon Rubber	S7508-A53J-MR-RB	24.94	R7508-A53J-MR-RB	20.28
						900	Tapered			Moldon Rubber - TB	S7508-A53J-MR-TB	24.95	R7508-A53J-MR-TB	20.29
2,500	Roller			Phenolic	S7508-A53J-PH-RB	20.70	R7508-A53J-PH-RB			16.04				
2,500	Roller			Solid Steel	S7508-A53J-SS-RB	32.80	R7508-A53J-SS-RB			28.14				
2,500	Roller			Moldon Urethane	S7508-A53J-UR-RB	27.14	R7508-A53J-UR-RB			22.48				
2,500	Tapered			Moldon Urethane - TB	S7508-A53J-UR-TB	30.65	R7508-A53J-UR-TB			26.00				
2,800	Roller			V Groove	S7508-A53J-VG-RB	32.08	R7508-A53J-VG-RB			27.42				
3,100	Roller			Moldon Urethane	S7508-A53J-URR-RB	31.80	R7508-A53J-URR-RB			27.14				
3,100	Tapered			Moldon Urethane - TB	S7508-A53J-URR-TB	29.95	R7508-A53J-URR-TB			25.29				
3,200	Tapered			Ductile Iron - TB	S7508-A53J-DI-TB	29.27	R7508-A53J-DI-TB			24.61				
3,200	Tapered			Solid Steel - TB	S7508-A53J-SS-TB	25.97	R7508-A53J-SS-TB			21.31				
3,200	Roller			Semi Steel	S7508-A53J-STR-RB	32.80	R7508-A53J-STR-RB			28.14				
3,200	Tapered			Semi Steel - TB	S7508-A53J-STR-TB	32.95	R7508-A53J-STR-TB			28.29				
3,200	Roller			HD Moldon Urethane	S7508-A53J-URH-RB	31.80	R7508-A53J-URH-RB			27.14				
3,200	Tapered	HD Moldon Urethane - TB	S7508-A53J-URH-TB	29.95	R7508-A53J-URH-TB	25.29								
3,200	Tapered	V Groove - TB	S7508-A53J-VGR-TB	37.45	R7508-A53J-VGR-TB	32.79								
10"	3"	1,000	Roller	7 9/16"	12 1/2"	Moldon Rubber	S7510-A53J-MR-RB	29.28	R7510-A53J-MR-RB	24.72				
		1,000	Tapered			Moldon Rubber - TB	S7510-A53J-MR-TB	31.45	R7510-A53J-MR-TB	26.89				
		2,500	Roller			Solid Steel	S7510-A53J-SS-RB	33.98	R7510-A53J-SS-RB	29.42				
		2,900	Roller			Phenolic	S7510-A53J-PH-RB	23.86	R7510-A53J-PH-RB	19.30				
		3,000	Roller			Moldon Urethane	S7510-A53J-UR-RB	31.90	R7510-A53J-UR-RB	27.34				
		3,000	Tapered			Moldon Urethane - TB	S7510-A53J-UR-TB	36.87	R7510-A53J-UR-TB	32.31				
		3,000	Roller			V Groove	S7510-A53J-VG-RB	37.26	R7510-A53J-VG-RB	32.70				
		3,200	Tapered			Ductile Iron - TB	S7510-A53J-DI-TB	40.97	R7510-A53J-DI-TB	36.41				
		3,200	Tapered			Solid Steel - TB	S7510-A53J-SS-TB	31.87	R7510-A53J-SS-TB	27.31				
		3,200	Roller			HD Moldon Urethane	S7510-A53J-URH-RB	39.26	R7510-A53J-URH-RB	34.70				
		3,200	Tapered			HD Moldon Urethane - TB	S7510-A53J-URH-TB	37.41	R7510-A53J-URH-TB	32.85				
		3,200	Roller			Moldon Urethane	S7510-A53J-URR-RB	39.26	R7510-A53J-URR-RB	34.70				
		3,200	Tapered			Moldon Urethane - TB	S7510-A53J-URR-TB	37.41	R7510-A53J-URR-TB	32.85				
		3,200	Tapered			Forged Steel V Groove - TB	S7510-A53J-VGFS-TB	40.41	R7510-A53J-VGFS-TB	35.85				

## PLATE DIAGRAMS

STANDARD PLATE: **A53J**

Plate Thickness: 3/8"

WHEEL		CASTER		PART NUMBER							
Diameter	Tread Width	Capacity Lbs.	Bearing Type	Swivel Radius	Overall Height	Wheel Type	Swivel	Caster Weight (lbs)	Rigid	Caster Weight (lbs)	
12"	3"	1,200	Roller	9"	14 1/16"	Moldon Rubber	S7512-A53J-MR-RB	34.88	R7512-A53J-MR-RB	29.60	
		1,200	Tapered			Moldon Rubber - TB	S7512-A53J-MR-TB	33.09	R7512-A53J-MR-TB	27.81	
		2,500	Roller			Solid Steel	S7512-A53J-SS-RB	40.42	R7512-A53J-SS-RB	35.14	
		3,200	Tapered			Ductile Iron - TB	S7512-A53J-DI-TB	45.44	R7512-A53J-DI-TB	40.16	
		3,200	Roller			Phenolic	S7512-A53J-PH-RB	28.12	R7512-A53J-PH-RB	22.84	
		3,200	Tapered			Solid Steel - TB	S7512-A53J-SS-TB	43.23	R7512-A53J-SS-TB	37.95	
		3,200	Roller			Moldon Urethane	S7512-A53J-UR-RB	38.16	R7512-A53J-UR-RB	32.88	
		3,200	Tapered			Moldon Urethane - TB	S7512-A53J-UR-TB	45.79	R7512-A53J-UR-TB	40.51	
		3,200	Tapered			HD Moldon Urethane -TB	S7512-A53J-URH-TB	39.07	R7512-A53J-URH-TB	33.79	
		3,200	Tapered			Moldon Urethane - TB	S7512-A53J-URR-TB	39.07	R7512-A53J-URR-TB	33.79	

